

DCR/ECR		REV.	REVISIONS DESCRIPTION	DATE	APPROVED

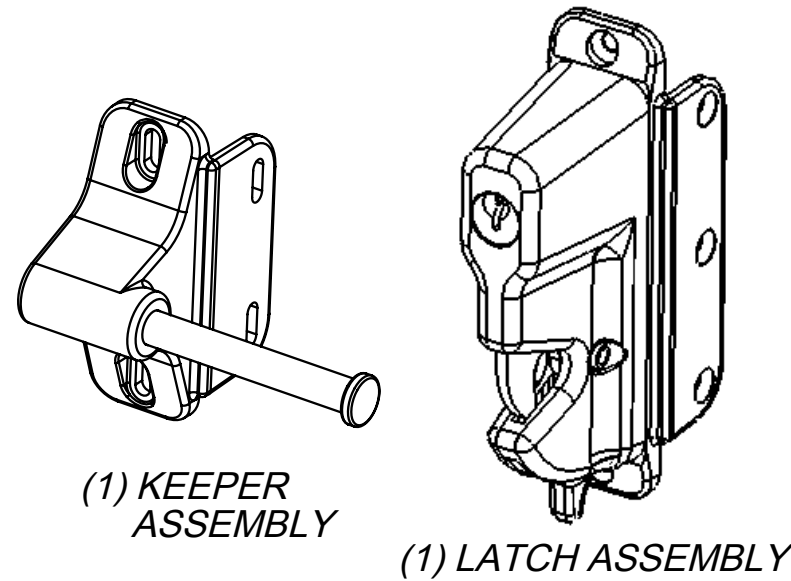

- PACKAGING INSTRUCTIONS:**
- 1) POLYBAG (4) KEEPER MOUNTING SCREW AND (5) LATCH MOUNTING SCREWS.
 - 2) POLYBAG (1) LATCH ASSY, (1) KEEPER ASSY, (1) MOUNTING SCREW PACK AND (1) INSTRUCTION SHEET.
 - 3) BOX (20) SETS PER CARTON.

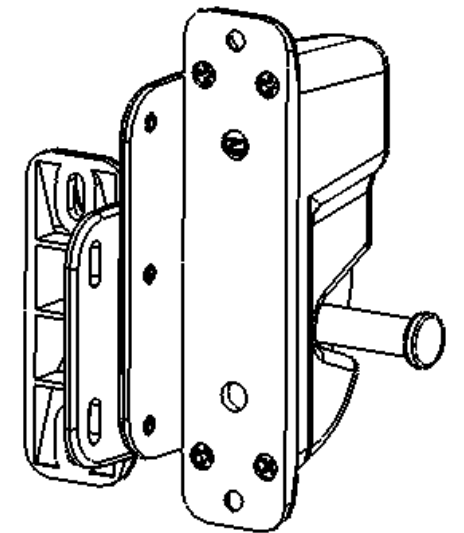
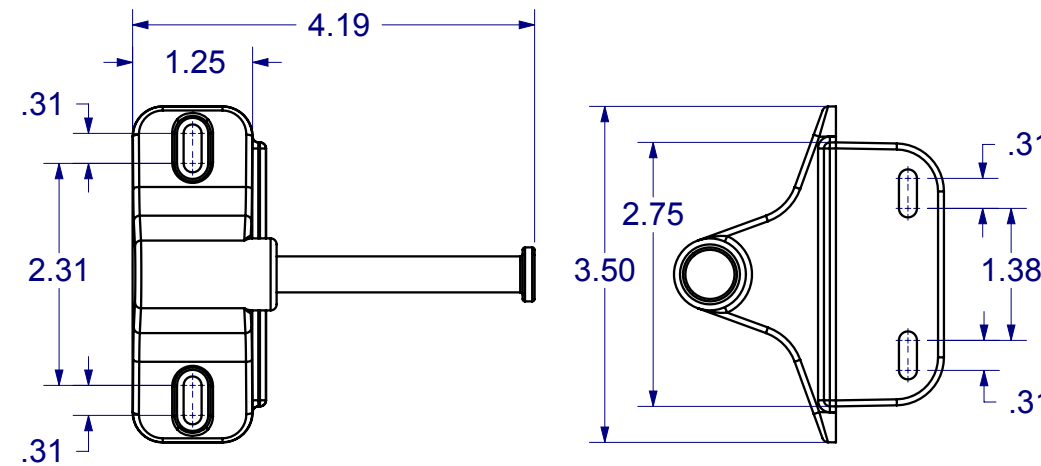
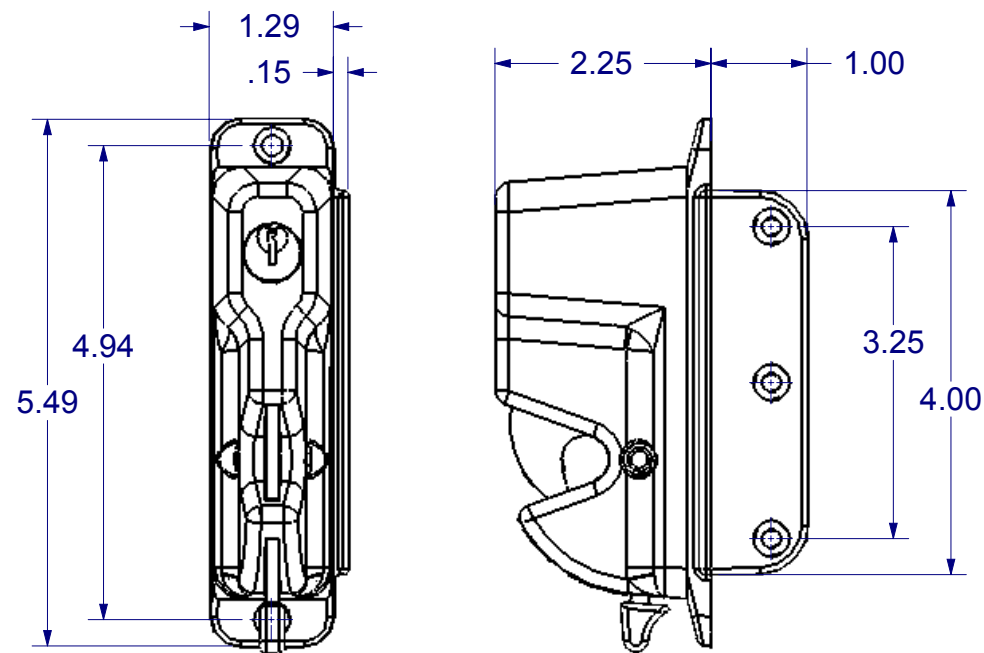
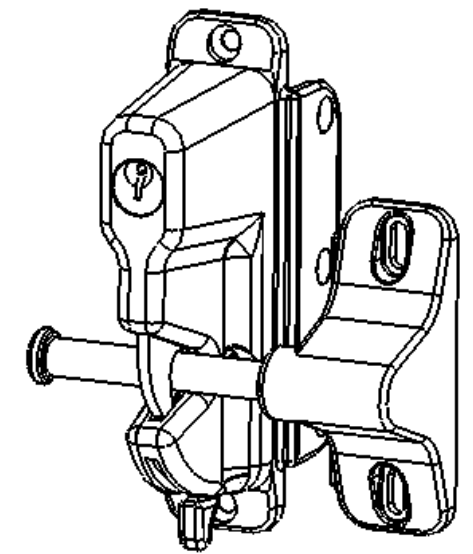

DIMENSIONS ARE IN INCHES TOLERANCES: FRACTIONAL ±1/16" ANGULAR: MACH ±1° BEND ±1° TWO PLACE DECIMAL ±0.01 THREE PLACE DECIMAL ±0.005		NAME EET	DATE 8-07-07						
MATERIAL GF NYLON / SST / STEEL FINISH ---		Q.A.	COMMENTS:						
<p>PROPRIETARY AND CONFIDENTIAL</p> <p>THE INFORMATION CONTAINED IN THIS DRAWING IS THE SOLE PROPERTY OF NATIONWIDE INDUSTRIES. ANY REPRODUCTION IN PART OR AS A WHOLE WITHOUT THE WRITTEN PERMISSION OF NATIONWIDE INDUSTRIES IS PROHIBITED.</p>		<table border="1"> <tr> <th>SIZE</th> <th>DWG. NO.</th> <th>REV.</th> </tr> <tr> <td>B</td> <td>CS-KLADVP1</td> <td>-</td> </tr> </table>	SIZE	DWG. NO.	REV.	B	CS-KLADVP1	-	<p>KEYSTONE ADVANTAGE™ AC</p> <p>SCALE: 1:2 WEIGHT: SHEET 1 OF 1</p>
SIZE	DWG. NO.	REV.							
B	CS-KLADVP1	-							

APPLICATION	DO NOT SCALE DRAWING